

| ITEM    | DESCRIPTION          | DRAWING |
|---------|----------------------|---------|
| 400-499 | WHEEL END COMPONENTS | B-24853 |

NOT SHOWN:

- 407 LUBRICANT
- 409 WHEEL NUTS
- 436 WHITE PASTE

**ASSEMBLY NOTES:**

1. ABS SENSOR INSTALLATION (DRUM BRAKES) ON PAGE 2.
2. WHEEL HUB, NUT, AND SEAL INSTALLATION PER HTES-1195 AND HTES-1196 OR L496 WHEEL-END MAINTENANCE PROCEDURES.
3. AXLE CAPS MUST BE REMOVED WHEN THE AXLE IS "DRESSED" WITH HUBS.
4. COMPONENT REPRESENTATIONS ARE REFERENCE ONLY. ACTUAL COMPONENT APPEARANCE MAY VARY.
5. HUB FILL REQUIREMENTS FOR #2 GREASE PER PAGE 2.
6. ♦INDICATES THESE PARTS ARE REQUIRED FOR THE TIREMAX TIRE INFLATION SYSTEM.

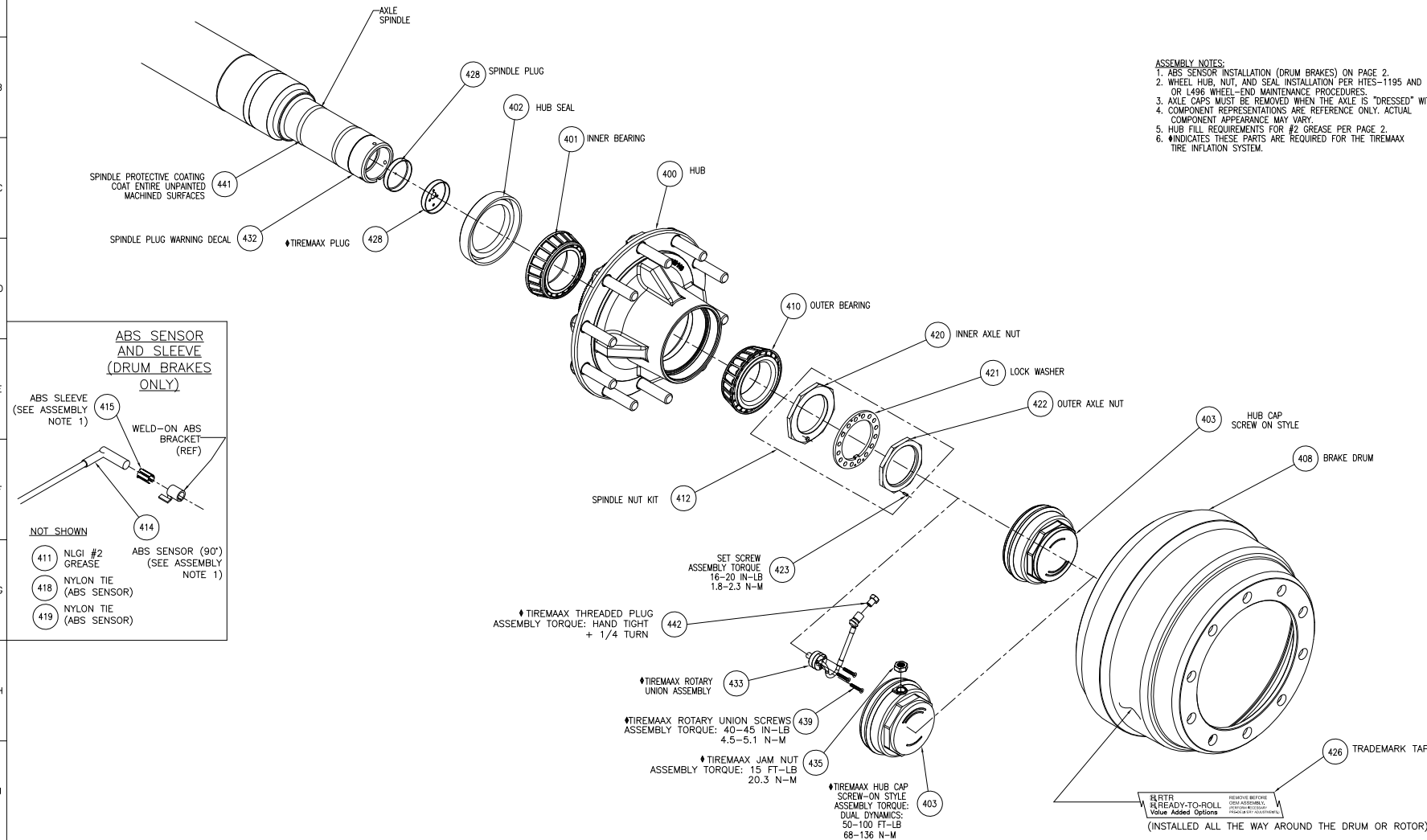

**ABS SENSOR AND SLEEVE (DRUM BRAKES ONLY)**

ABS SLEEVE (SEE ASSEMBLY NOTE 1)

WELD-ON ABS BRACKET (REF)

NOT SHOWN

- 411 NLGI #2 GREASE
- 418 NYLON TIE (ABS SENSOR)
- 419 NYLON TIE (ABS SENSOR)
- 414 ABS SENSOR (90°) (SEE ASSEMBLY NOTE 1)

- NOTES:**
1. COMPONENT REPRESENTATION ARE REFERENCE ONLY. ACTUAL COMPONENT APPEARANCE MAY VARY.
  2. REFER TO DOCUMENT R-HSDS FOR MODEL DOCUMENTATION.
  3. REFER TO DOCUMENT B-32596 FOR AFTERMARKET PARTS LIST

This print remains the property of Hendrickson. All information contained thereon is confidential. It is loaned, subject to return on demand, and on the express condition that it is not to be copied or used directly or indirectly for any purpose other than the purpose for which it has been loaned to you.

|  |  |   |  |                      |      |                      |           |         |
|--|--|---|--|----------------------|------|----------------------|-----------|---------|
| <b>HENDRICKSON</b>   |  | UNLESS OTHERWISE NOTED:   |  | FORM NO.             | REV. | DATE                 | SIZE      | PAGE    |
| TRAILER COMMERCIAL VEHICLE SYSTEMS                         |  | TOLERANCES ARE:<br>X: ± 0.2<br>Y: ± 1.5<br>Z: ± 0.75<br>ANGULAR: ± 0.01°            |  | M 6220               | 0    | 2009                 | MCD       | 8-29-11 |
| 200 HENDRICKSON PLACE, L.L., CANON, NJ, 07030-1002, U.S.A. |  | DRAWING ARE:<br>UNLESS OTHERWISE NOTED:<br>BY: C. ANDERSON<br>CHECKED BY: M. OYSTER |  | REV. ECH NO. BY DATE |      | REV. ECH NO. BY DATE |           | 1:4     |
| HSDS WHEEL END COMPONENTS                                  |  |   |  |                      |      |                      | 1 OF 2    |         |
|  |  |   |  |                      |      |                      | D D-32594 |         |

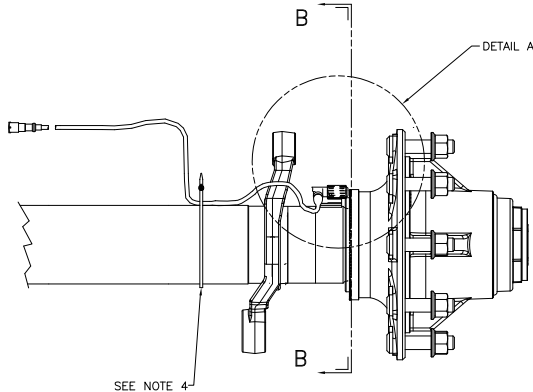

SEE NOTE 4

**VIEW BB**

SCALE: .25=1.00

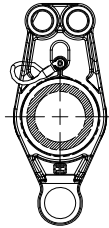

SEE NOTE 5

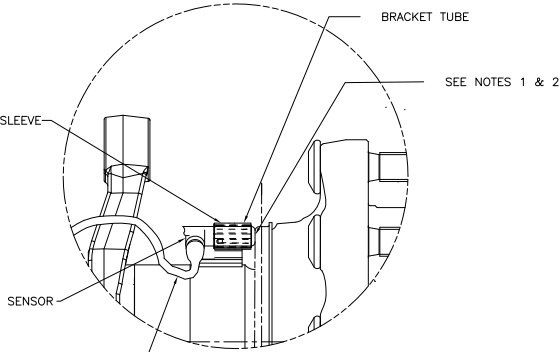

**DETAIL A**

SCALE: .50=1.00

**ABS SENSOR INSTALLATION NOTES:**

1. INSTALL SENSOR RETAINING SLEEVE BY COMPRESSING THE O.D. OF THE SLEEVE UNTIL THE SLEEVE CAN BE INSERTED INTO THE I.D. OF THE ABS SENSOR BRACKET. INSERT THE SLEEVE FROM THE INBOARD SIDE OF THE AXLE AND PRESS THE SLEEVE TOWARD THE OUTBOARD END OF THE AXLE UNTIL THE BENT OVER TABS ON THE SLEEVE CONTACT THE END OF THE BRACKET TUBE.
2. INSERT THE SENSOR INTO THE INBOARD SIDE OF THE ABS SENSOR BRACKET AFTER THE SLEEVE HAS BEEN INSTALLED. PRESS THE SENSOR IN UNTIL IT MAKES CONTACT WITH THE ABS TONE RING INSTALLED ON THE HUB.
3. FEED THE SENSOR CABLE AROUND THE AXLE.
4. FASTEN SENSOR CABLE TO THE AXLE IN ONE PLACE AS SHOWN USING NYLON WIRE TIE. SECURE THE CABLE SO THAT IT WILL NOT CHAFF OR RUB AGAINST THE DRUM OR BRAKE RIGGING.
5. DO NOT FORM A COIL WITH EXCESS CABLE. WRAP EXCESS CABLE BACK ON ITSELF AS SHOWN IN THE DIAGRAM ABOVE.

This print remains the property of Hendrickson. All information contained thereon is confidential. It is loaned, subject to return on demand, and on the express condition that it is not to be copied or used directly or indirectly for any purpose other than the purpose for which it has been loaned to you.

**GREASE INSTALLATION**

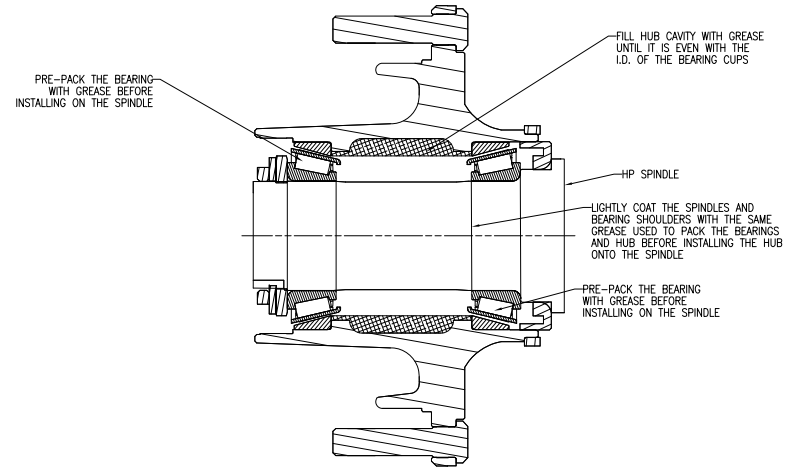

SCALE 1:2

**HENDRICKSON**

TRAILER COMMERCIAL VEHICLE SYSTEMS  
2000 HIGHLAND, FAIRFAX, VA 22033, U.S.A.

|                                     |        |                               |                         |                        |
|-------------------------------------|--------|-------------------------------|-------------------------|------------------------|
| UNLESS OTHERWISE NOTED:             |        | DRUMING ARE: <b>UNDRUMING</b> | DRUM NO. <b>M. GEZO</b> | DATE: <b>03-Nov-11</b> |
| TOLERANCES ARE:                     | ± .02  | ± .05                         | ± .10                   | ± .15                  |
| ANGULAR: ± 0.01                     | ± 0.02 | ± 0.05                        | ± 0.10                  | ± 0.15                 |
| DRUMING: PERFORM TO AHS 114.00-1102 | REV: 5 | 2009                          | MCD                     | 11-3-11                |
| REV: 5                              | 2009   | MCD                           | 11-3-11                 | DATE                   |

|                                 |   |
|---------------------------------|---|
| DESIGNED BY: <b>C. ANDERSON</b> | THE DRAWING IS THE CONFIDENTIAL PROPERTY OF HENDRICKSON |
| APPROVED BY: <b>M. OYSTER</b>   |   |

HSDS WHEEL END COMPONENTS

|            |                         |
|------------|-------------------------|
| SCALE: 1:4 | PAGE: 2 OF 2            |
| REV: D     | DRAWING NUMBER: D-32594 |