

# TECHNICAL PROCEDURE INTRAAX®

**SUBJECT:** Shock Mount Assembly Procedure

**LIT NO:** L635

**DATE:** February 2014

**REVISION:** E

Hendrickson uses a shear-type bolt in the lower shock absorber connection on many suspensions. To obtain the proper clamp load, install hardened washers on each side of the shock absorber bushing (Figure 1), or install the shock strap clevis (Figure 2), and tighten the shear-type bolt until the bolt's Torx head shears off. Use an E20 Torx socket to tighten and shear the bolt. Torx head separation occurs between  $222 \pm 12$  ft. lbs. ( $300 \pm 15$  N•m) of torque.

The upper shock mount is tightened to 225 ft. lbs. (305 N•m) of torque (Figure 4).

AANLS uses a hex head cap screw for the lower shock bolt. Tighten to 225 ft. lbs (305 N•m) of torque.

Failure to follow these instructions could result in damage to the suspension and / or its components.

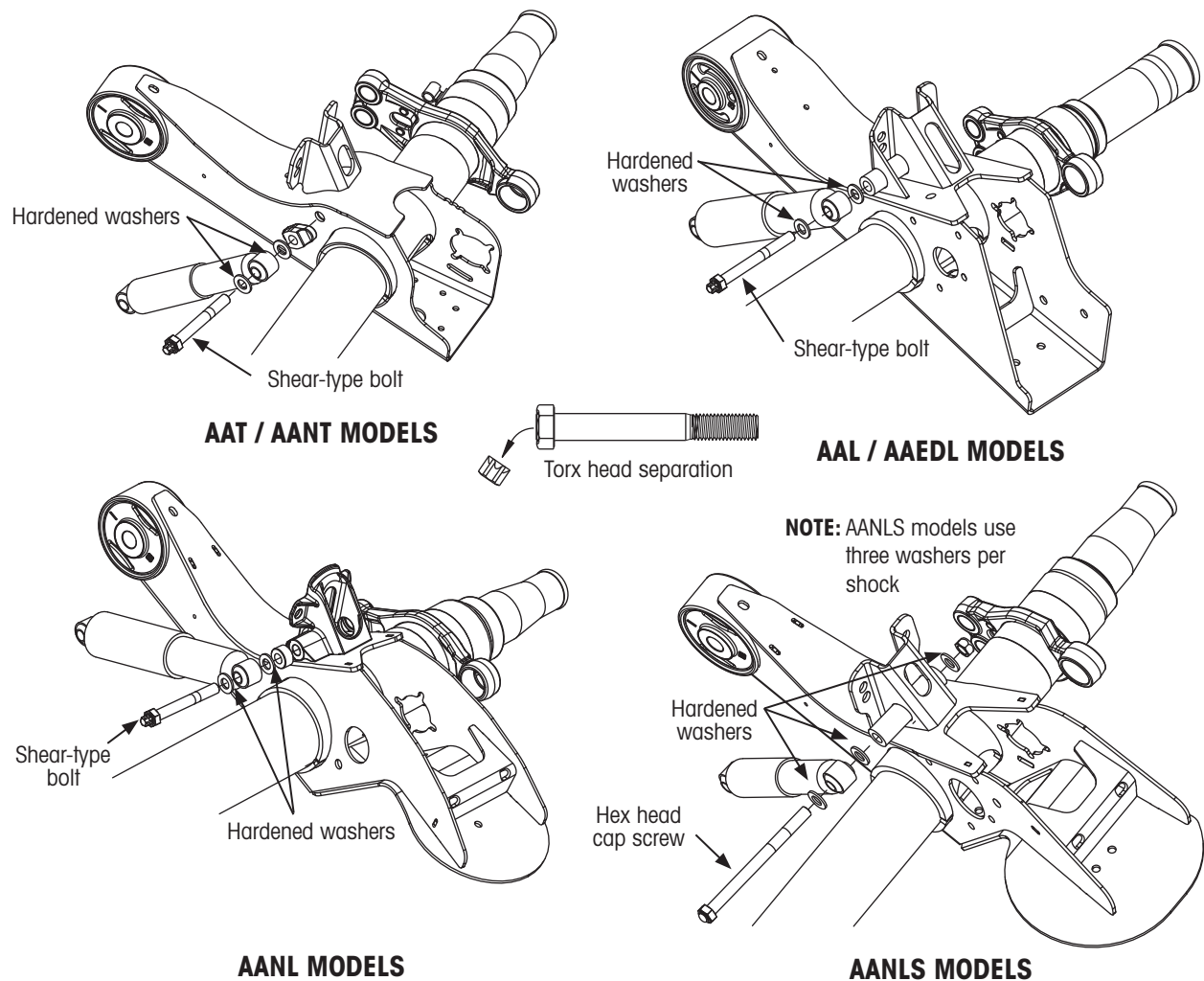

Figure 1: Lower shock mount assembly on suspensions without shock straps

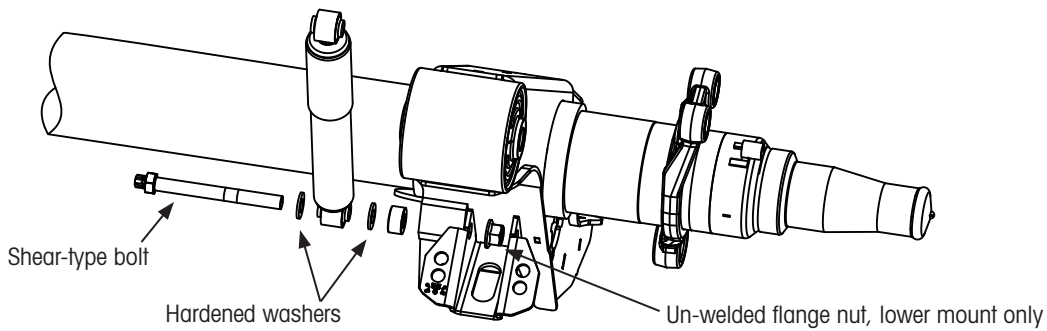

Figure 2: AAL lower shock mount with LDA axle

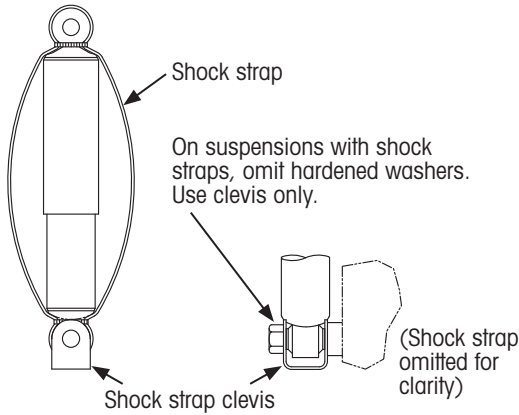

Figure 3: Lower shock mount assembly on suspensions with shock straps

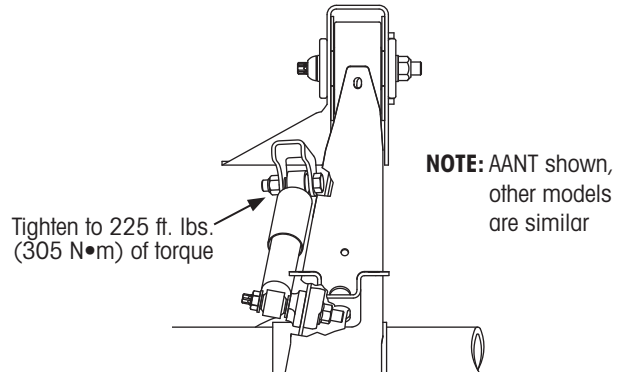

Figure 4: Upper shock mount assembly

If the nut on the inside of the suspension beam is damaged or cannot be reused (i.e., threads are stripped, nut is cracked, etc.), drill out the threads in the lower shock mounting block inside the suspension beam (Figure 5) and use the extra washer and nut provided in the shock bolt service kit to complete the lower shock mount.

Refer to Hendrickson publication *L724 Shock Mount Replacement Procedures* for more details on AAT and AANT model shock mount repair. For more details on AAT, AANT or AAL, AAEDL, AAEDT and AANLS model shock mount repair contact Hendrickson Technical Services in the United States and Canada at 866-RIDEAIR (743-3247) or in Mexico at +52 (442) 296-3600.

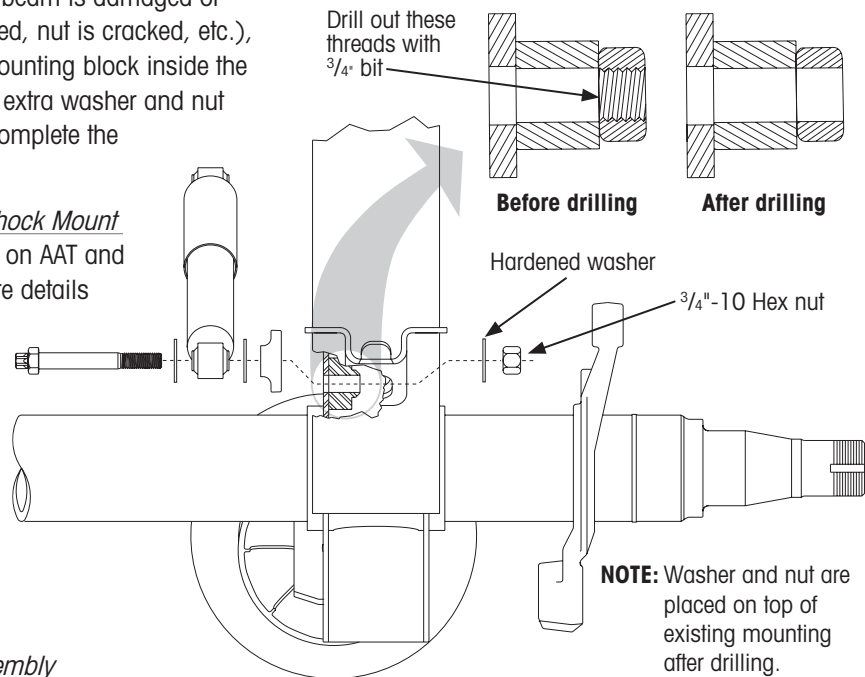

Figure 5: Damaged thread hardware assembly

www.hendrickson-intl.com



Hendrickson Canada  
250 Chrysler Drive, Unit #3  
Brampton, ON Canada L6S 6B6  
905.789.1030  
Fax 905.789.1033

Trailer Commercial Vehicle Systems  
2070 Industrial Place SE  
Canton, OH 44707-2641 USA

866.RIDEAIR (743.3247)  
330.489.0045  
Fax 800.696.4416

Hendrickson Mexicana  
Circuito El Marqués Sur #29  
Parque Industrial El Marqués  
Pob. El Colorado, Municipio El Marqués,  
Querétaro, México C.P. 76246  
+52 (442) 296.3600  
Fax: +52 (442) 296.3601