

This Print remains the property of Hendrickson. All information contained thereon is confidential. It is loaned, subject to return on demand and on express condition that it is not to be copied or used directly or indirectly for any purpose other than the purpose for which it has been loaned to you.

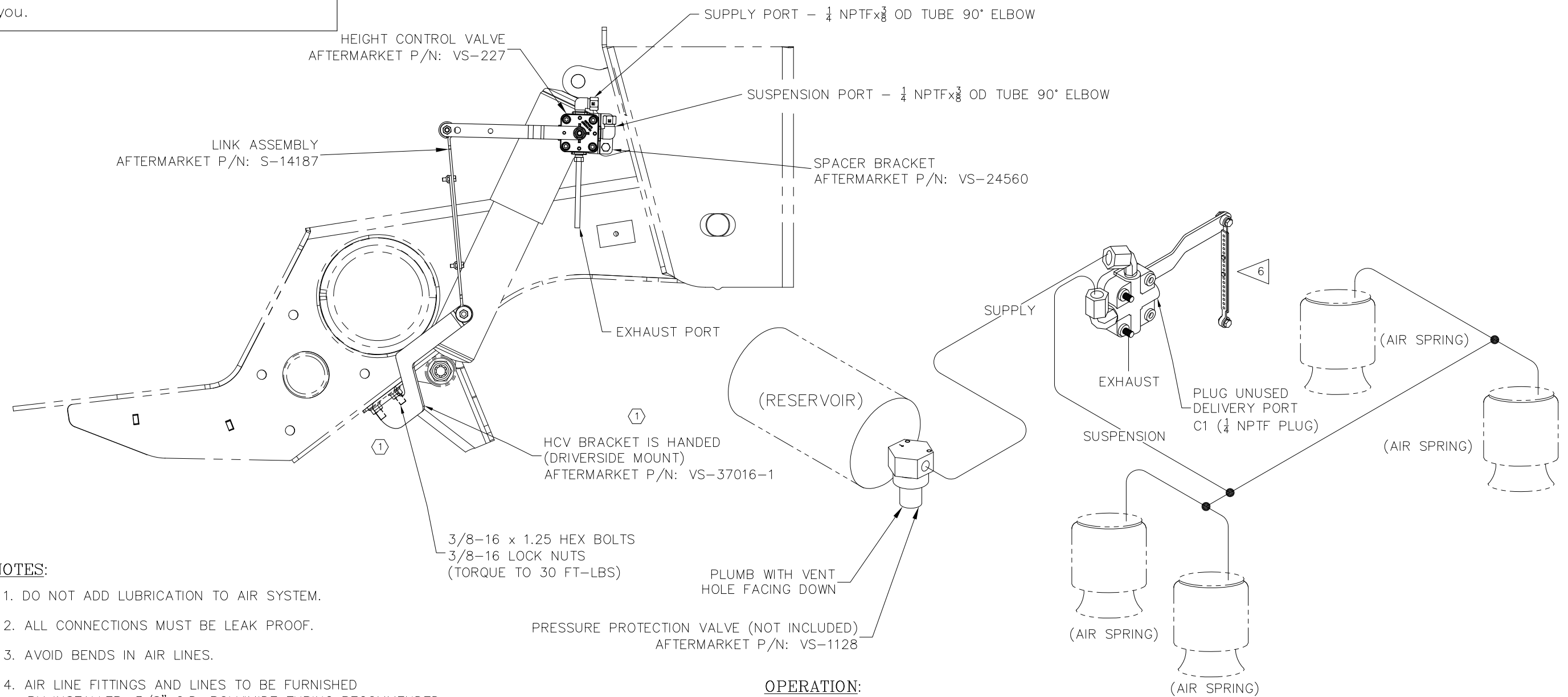

NOTES:

1. DO NOT ADD LUBRICATION TO AIR SYSTEM.
2. ALL CONNECTIONS MUST BE LEAK PROOF.
3. AVOID BENDS IN AIR LINES.
4. AIR LINE FITTINGS AND LINES TO BE FURNISHED BY INSTALLER. 3/8" O.D. POLYIMIDE TUBING RECOMMENDED.
5. APPLICATION - ALL TRAILERS USING INTRAAX® AAL, KIT NOT COMPATIBLE WITH AAEDL, AND AAEDT SUSPENSION MODELS
6. TRIM & BOLT LINKS AS REQ'D TO HOLD HEIGHT CONTROL VALVE IN NEUTRAL POSITION WHEN SUSPENSION IS AT RIDE HEIGHT.
7. AIR UP SUSPENSION UNTIL AXLE IS SET AT PROPER RIDE HEIGHT. INSERT LOCATING PIN IN HCV CONTROL ARM TO HOLD ARM IN NEUTRAL POSITION. INSTALL ONE END OF THE LINK TO THE HEIGHT CONTROL VALVE. INSTALL THE OTHER LINK END IN MOUNTING BRACKET. INSTALL LINK FASTENERS AND TIGHTEN NUTS. DO NOT OVER-TIGHTEN LINK FASTENERS, LINK SHOULD ROTATE FREELY.

OPERATION:

VALVE ARM HORIZONTAL
 FRAME IS AT PRESET HEIGHT
 NO AIR FLOW OCCURRING.

VALVE ARM DOWN
 FRAME IS HIGH, AIR SPRINGS
 ARE EXHAUSTED UNTIL ARM
 IS HORIZONTAL.

VALVE ARM UP
 FRAME IS LOW, AIR SPRINGS
 ARE INFLATED UNTIL ARM
 IS HORIZONTAL.

FUNCTION:

AUTOMATIC HEIGHT CONTROL.

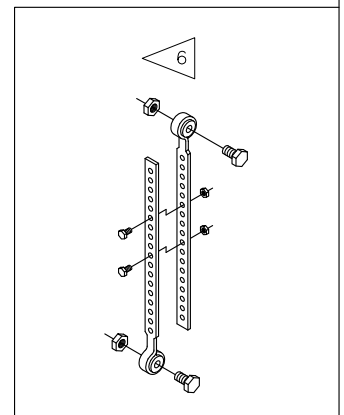

TRAILER COMMERCIAL VEHICLE SYSTEMS
 2070 INDUSTRIAL PLACE S.E., CANTON, OH 44707-2600 U.S.A.

UNLESS OTHERWISE NOTED: TOLERANCES ARE:		DIMENSIONS ARE:		BY		DATE	
.X: ± .1	.XX: ± .06	.XXX: ± .030	ANGULAR: ± 0.5°	1	25101	CCV	03-03-16
3RD ANGLE PROJECTION				0	23172	NWD	6/23/14
DIMENSIONS ADHERE TO ANSI Y14.5M-1982				REV.	ECN NO.	BY	DATE

DRAWN BY	N. DUXBURY	DATE	6/23/14
CHK'D BY	C. VAN DYKE		
APP'D BY:	J. CERVAITEZ		

THIS DRAWING IS
 THE CONFIDENTIAL
 PROPERTY OF
 HENDRICKSON

HCV KIT
 FOR AAL LDA

SCALE	PAGE
.25=1.00 (SIZE)	1 OF 1 DRAWING No.
AKH0309CD	