

CAM TUBE SYSTEM™

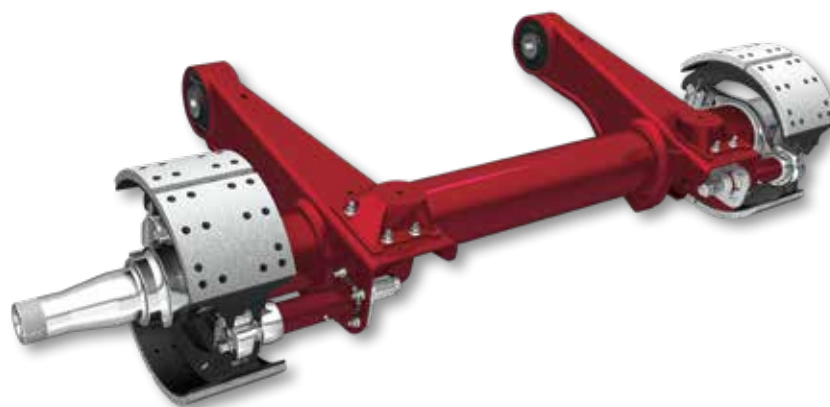

Hendrickson's revolutionary Cam Tube System™ is patented with a unique 4-tabbed design. Engineered to perform, this 4-tabbed Cam Tube System is manufactured with tight tolerances creating a clamping force that is symmetric around the cam tube.

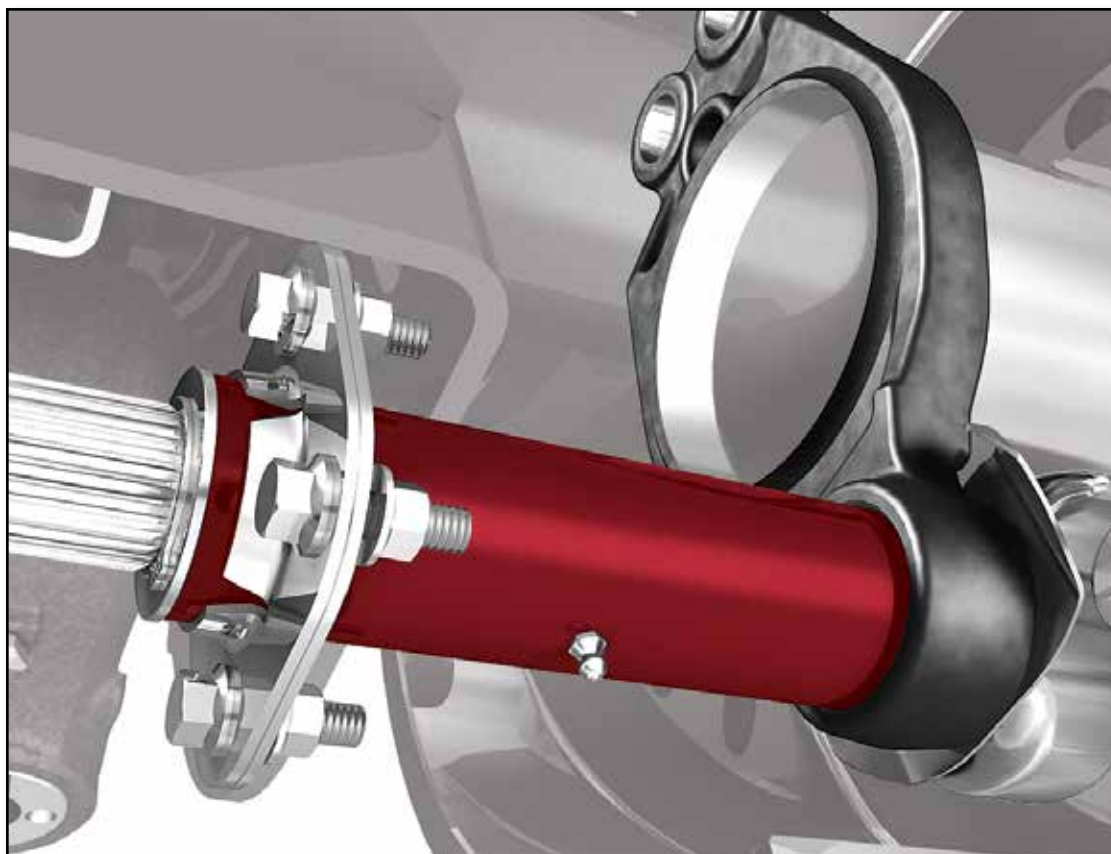

H GENUINE PARTS

* Contact Hendrickson for complete warranty terms, conditions and limitations.

To learn more about Cam Tube System,
call 866.743.3247 or visit www.hendrickson-intl.com

H HENDRICKSON
The World Rides On Us®



Hendrickson's 4-Tabbed Design

Competitor's 2-Tabbed Design

Competitor's O-Ring Design

Structural Design

Hendrickson's 4-tabbed design is manufactured to perform.

- The symmetric clamping holds the cam tube in position to help prevent cam tube rotation, which can cause premature wear to the brake spiders and could result in an expensive replacement of the HALFTRAAX™ axle / beam weldment.

Bent washer design provides increased durability and resistance to rotation versus the flat design.

- Bent to allow the washer to be common between a 15" and 16.5" diameter INTRAAX® brake.

Mechanical Properties

Hendrickson's cam tube clamping bracket is manufactured using high-strength, low alloy, high quality steel.

- On certain will-fit brands of cam tubes, testing indicates the clamping bracket mechanical properties have a lower torque causing less resistance to movement than Hendrickson's bracket.
- The clamping force will not deform the plate.

Hendrickson's cam tube bushing has internal lubricants to reduce friction and extend wear life.

- Many competitor bushings are glass-filled nylon and have NO internal lubricants.

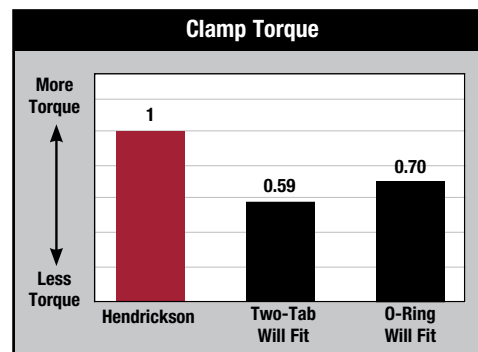

Above clamp torque data is based upon internal testing



NOTE: Look for the orange label with the black-filled slack adjuster image and **L748 B 08-05** on the bottom edge of the label to ensure that it is a Hendrickson Genuine Part.

These products are covered by at least one or more U.S. and / or foreign patents and / or pending U.S. and / or foreign patent applications. See Hendrickson for details.

Actual product performance may vary depending upon vehicle configuration, operation, service and other factors.

All applications must comply with applicable Hendrickson specifications and must be approved by the respective vehicle manufacturer with the vehicle in its original, as-built configuration.

Contact Hendrickson for additional details regarding specifications, applications, capacities, operation, service and maintenance instructions.

Call Hendrickson at 330.489.0045 or 866.RIDEAIR (743.3247) for additional information.



www.hendrickson-intl.com



TRAILER COMMERCIAL VEHICLE SYSTEMS
2070 Industrial Place SE
Canton, OH 44707-2641 USA
866.RIDEAIR (743.3247)
Fax 800.696.4416

HENDRICKSON CANADA ULC
2825 Argentina Road, Unit #1 - 4
Mississauga, ON Canada L5N 8G6
800.668.5360
905.789.1030 • Fax 905.812.9423

HENDRICKSON MEXICANA
Circuito El Marqués Sur #29
Parque Industrial El Marqués
Pob. El Colorado, Municipio El Marqués,
Querétaro, México CP 76246
+52 442.296.3600 • Fax +52 442.296.3601