

H LOOSE AXLES SPECIFICATION GUIDE

LIT NO: H722

DATE: August 2019

REVISION: J

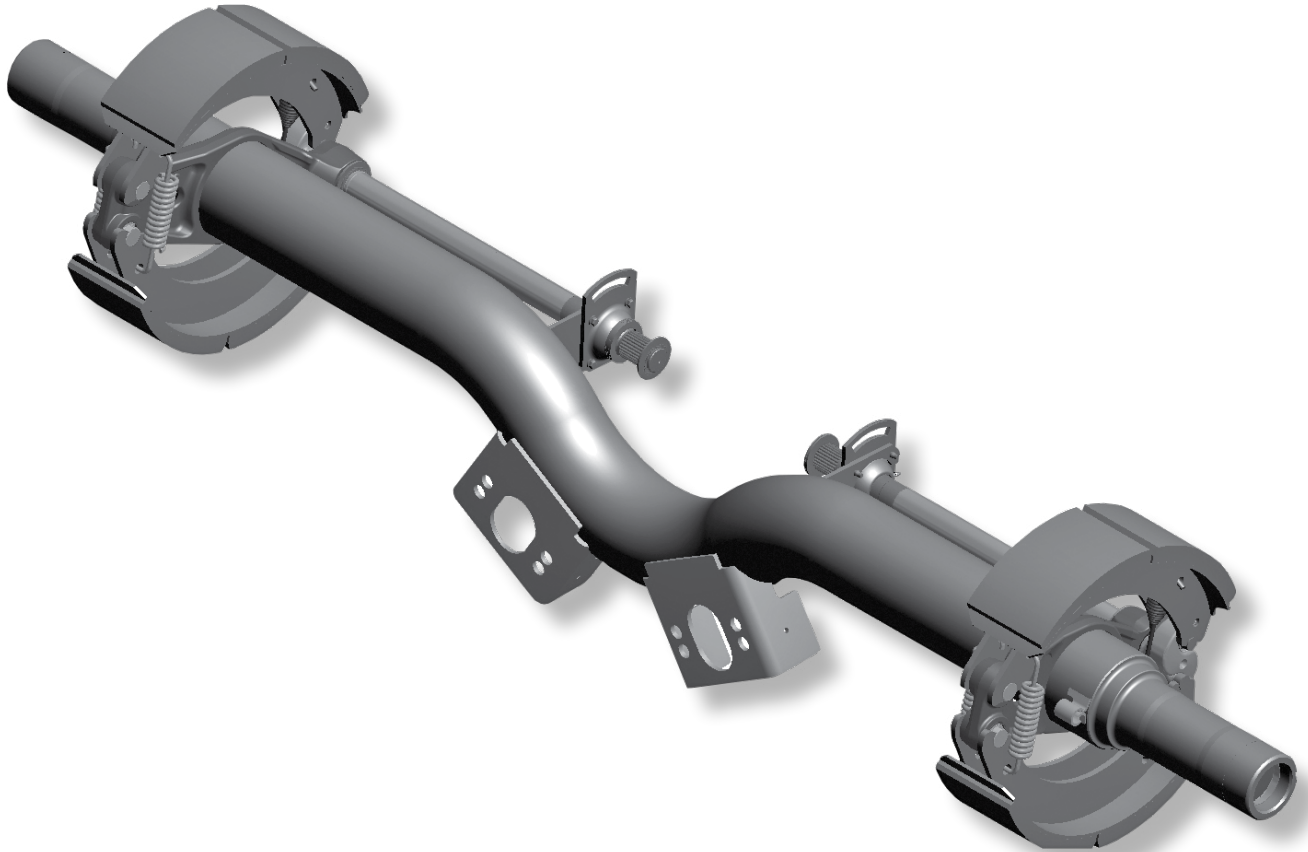

LOOSE AXLES SPECIFICATION GUIDE

Call Hendrickson at:

For additional information and application specifications, call 1.800.660.2829 in the U.S. or 1.800.668.5360 in Canada.

e-mail LiftAxleTech@hendrickson-intl.com
fax **1.740.929.5601**

SPECIFICATION REQUESTER – REQUIRED INFORMATION

Company Name:	Request Date:
Contact Person:	City, State, Zip:
Telephone:	E-mail Address:

Is this a "same-as" purchase to replace a previously purchased model?

Yes → Enter Spicer-Dana® or Hendrickson model number and proceed to application below:

1 LOOSE AXLE APPLICATION & CAPACITY SELECTION

SPINDLE TYPE:	D22–HN	P22–HP	K22	K30	S22	S30	A45	A65	HAUX picks best	
AXLE STYLE:	Straight		Bent (See page 3 for drawing)							
AXLE DIAMETER:	5" OD	5.75" OD	6" OD							
AXLE WALL:	1/2" (Mechanical Springs Only)			5/8"	3/4"					
MAXIMUM LOAD CAPACITY¹:	16K	20K	23K	25K	30K	45K	65K			
TRACK LENGTH²:	71.5"	77.5"	Other						(See image at bottom of this page.)	

2 LOOSE AXLE OPTIONS

BRAKE CHAMBER³:	No (Size:)	Yes →	Port towards axle (Standard)	Port away from axle
BRAKE CHAMBER SIZE:	Type 24	Type 30	Type 30/30	Other:
BRAKE SLACK ADJUSTER³:	No (Size:)	Yes →	5.5"	6.0" Manual
ABS SENSOR:	No	Yes (ABS Sensor Bracket will be included regardless of selection.)		
CAM COVER:	No	Yes		
BRAKES:	No (Size:)	Yes →	16.5 × 7 (Standard)	Other
S-CAM:	No	Yes, If yes; 28–spline (Standard) or 10–spline		
	REQUIRED! Indicate Length:		OR Air Chamber Centers (ACC):	
PAINT:	No	Yes		
HUB / DRUMS⁴:	No: REQUIRED! Provide Vendor Part #:		Yes (Hub pilot and long studs, standard) ⁵	
WHEEL MATERIAL⁶	Steel	Aluminum		
HUB MATERIAL	Iron	Aluminum		
LUBRICATION⁷:	No	80/90 Oil (Standard)	L2 Grease	
DUST SHIELD:	No	Yes (Available only for 16.5" brake size)		
4–PIECE SPINDLE NUT KIT:	No	Yes (Automatically included only if Hub/Drums are selected.)		

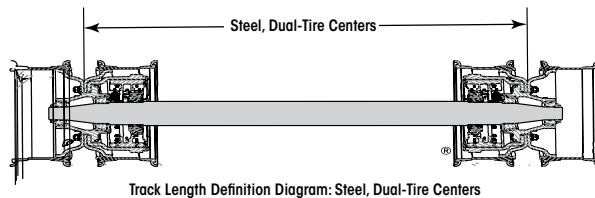

3 BENT TUBE AXLE SPACING AND ORIENTATION

HUMP INSTALLATION ORIENTATION:

Rear Down (Standard) S-Cam Angle: 0° 10° 15° 22.5° 25°
 9.5" ACC or greater is required. Must receive Hendrickson approval for anything less.

Front Up
 16.0" ACC or greater is required. Must receive Hendrickson approval for anything less.

HUMP DOWN/REAR DOWN

HAUX's Axle Orientation Convention for Rear-Down Part Number Configuration

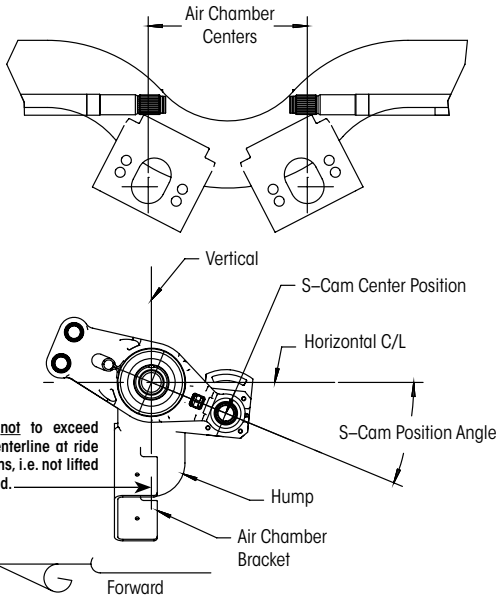

HUMP DOWN/FRONT UP

HAUX's Axle Orientation Convention for Front-Up Part Number Configuration

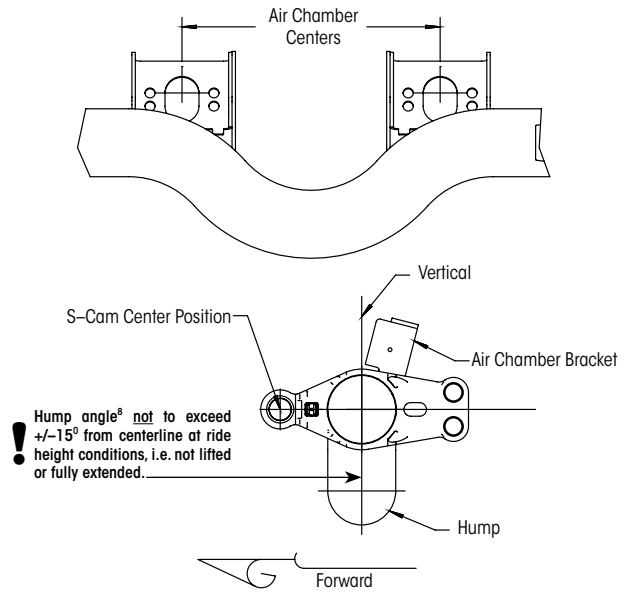

Alternative Axle Orientation by Customer with the Same Rear-Down Part Number Configuration
 Note: All Hump-Up Axles have 3/4" Axle Wall Thickness.

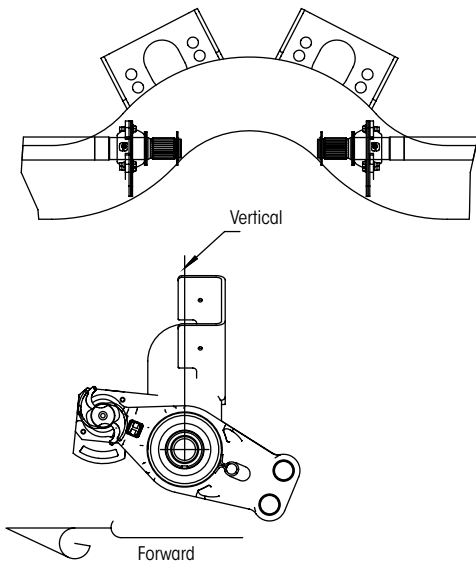

Alternative Axle Orientation by Customer with the Same Front-Up Part Number Configuration
 Note: All Hump-Up Axles have 3/4" Axle Wall Thickness.

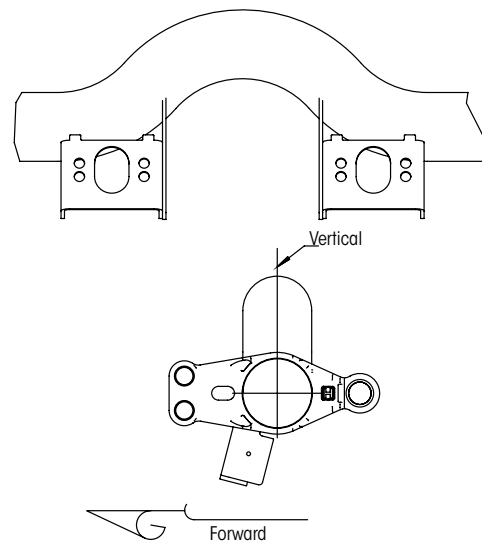

IMPORTANT! ALL ENGAGING CAMS MUST ROTATE THE SAME AS THE WHEELS IN FORWARD MOTION; OPPOSITE CAM ROTATION CAUSES COMPONENT FAILURE. HUMPS MUST BE WITHIN 15 DEGREES OF VERTICAL AS SHOWN ABOVE, AND OPERATED AT THE SPECIFIED RIDE HEIGHT. ANY APPLICATION OTHER THAN STATED ABOVE WILL VOID THE WARRANTY.

Explanations to the notes on page 2 and 3:

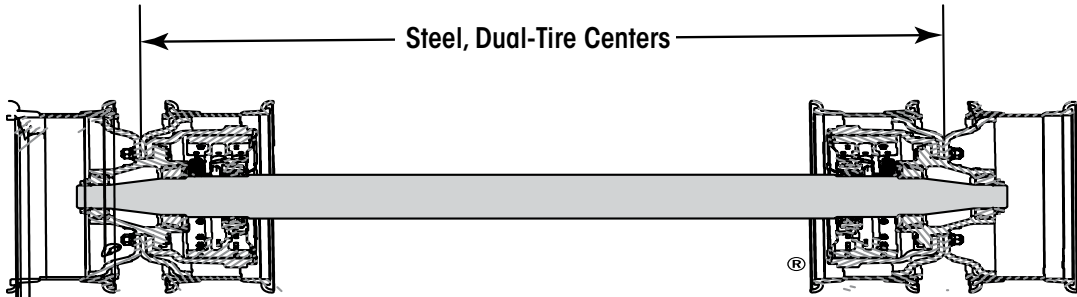
Note ¹	Follows standard axle, spindle, and brake offerings.
Note ² (See Note 6!)	Track lengths are centers of dual steel wheel tires available in 1/2" increments. For aluminum wheels subtract 1" from track length. For aluminum outer wheels/steel inner wheels, subtract 1/2" from track length.
	 <p style="text-align: center;">Track Length Definition Diagram: Steel, Dual-Tire Centers</p>
Note ³	Size is set by standard (note ¹). Brake chambers must be accompanied by slacks.
Note ⁴	Knowing the hub and drum for the axles helps Hendrickson locate the brakes on the axle. This information is required.
Note ⁵	Typical stud bolt circle: D22 and P22 = 11-1/4"; A45 and A65 = 13-3/16". Please inquire for other pilot, stud length and bolt circle choices. Standard is outboard, cast drum.
Note ⁶	<p>!Very Important! Due to the different backing plate thickness of aluminum wheels, the use of aluminum wheels as the inner wheel can lead to a situation where bearings can become over-loaded. Please read and understand the following:</p> <p>Before beginning the installation process, verify that your suspension meets the requirements of your intended vehicle and application: Actual product performance may vary depending upon vehicle configuration, operation, service and other factors. All applications must comply with applicable Hendrickson specifications and must be approved by the respective vehicle manufacturer with the vehicle in its original, as-built configuration. Any axle system's weight rating is limited by the lowest rating of any constituent component installed into or onto that system. The tire and rim specifications, orientation and load location can also affect the rating of the hubs and hence the axle and suspension system rating as a whole. It is the installer's responsibility to ensure that the axle system's rating (which may be reduced, as indicated above) is not exceeded. Failure to do this can result in damage to the axle. A particular concern is the possible "de-rating" of axle capacity when using offset (dished-out or dished-in) wheels, or in the case of dual-tire application - aluminum inner wheels, a situation that can put an excessive load on the bearings and spindle, which can lead to reduced service life and mechanical failures. When utilizing hubs, wheels or bearings not supplied by or recommended by Hendrickson or when replacing Hendrickson-supplied hubs and/or bearings with components not supplied by Hendrickson, it is the buyer's responsibility to consult with the suppliers of those components and all associated supplier literature to assure that the rated capacity of the axle system or its sub-assemblies will not be exceeded.</p>
Note ⁷	All hub lubrication unless otherwise specified will be 80/90W oil, except for A65; A65 will have L2 grease.
Note ⁸	Hump angle <u>not</u> to exceed +/-15° from centerline at ride height conditions, i.e. not lifted or fully extended.

Actual product performance may vary depending upon vehicle configuration, operation, service and other factors.

All applications must comply with applicable Hendrickson specifications and must be approved by the respective vehicle manufacturer with the vehicle in its original, as-built configuration. Contact Hendrickson for additional details regarding specifications, applications, capacities, and operation, service and maintenance instructions.

Call Hendrickson at 800.660.2829 or 800.668.5360 in Canada for additional information.



www.hendrickson-intl.com

**SPECIALTY PRODUCTS -
AUXILIARY AXLE SYSTEMS**

277 North High Street
Hebron, OH 43025 USA
800.660.2829
740.929.5600 • Fax 740.929.5601

Hendrickson Canada

250 Chrysler Drive, Unit #3
Brampton, ON Canada L6S 6B6
800.668.5360
905.789.1030 • Fax 905.789.1033

H722 Rev J 08-19

© 2019 Hendrickson USA, L.L.C. All Rights Reserved. All trademarks shown are owned by Hendrickson USA, L.L.C., or one of its affiliates, in one or more countries.

Information contained in this literature was accurate at the time of publication. Product changes may have been made after the copyright date that are not reflected.

Printed in United States of America